

Wire max. section:
 single wire (rigid): 2,5mm²
 multi wire (flexible): 1,5mm²
 multi wire with cover: 1,5mm²

A-A

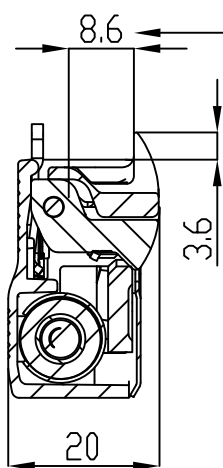

Theoretical position
 +/-1mm adjustment

**REF. CORTIZO
 301062**

Specifications	
- Voltage: 6-12V AC/DC	A01
- Latch section for latch slide	R
- Mechanical release lever	E
- 9mm screw hole position	9
- Without reporting contact	0
- Without hold-open function	0

DESCRIPTION		ELECTRIC STRIKE 6-12V AC/DC	
CLIENT	REF. 1-0888-004K/4	DATE	19/12/2016
SCALE	1 : 1	DESIGNED BY	A. H. G.
MATERIAL	FINISH:	ART. N.	91RYA01RE90